

8 7 6 5 4 3 2 1

NOTES:

1. MATERIAL: STAINLESS STEEL SHEET, TYPE 304 PER ASTM A240.
2. VIBRO-ETCH PART WITH DRAWING NUMBER WITH MIN .12 HIGH CHARACTERS IN ACCORDANCE WITH MIL-STD-130, LOCATE APPROX AS SHOWN.

REVISION APPROVALS								
REV	ECN NO.	DESCRIPTION	DATE	BY	CHK	DES	ENG	SUPV
A	-	INITIAL RELEASE	-	-	-	-	-	-

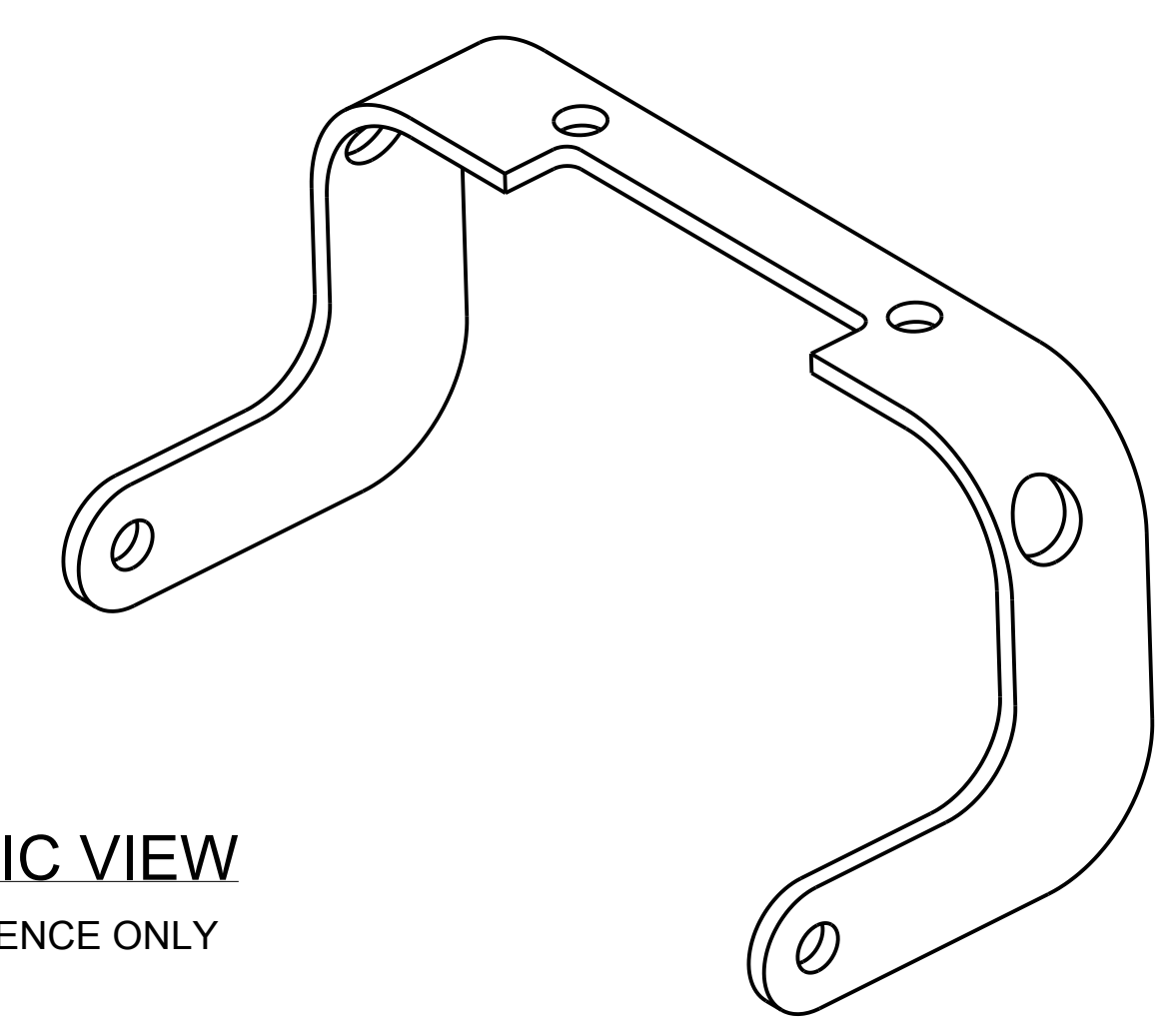
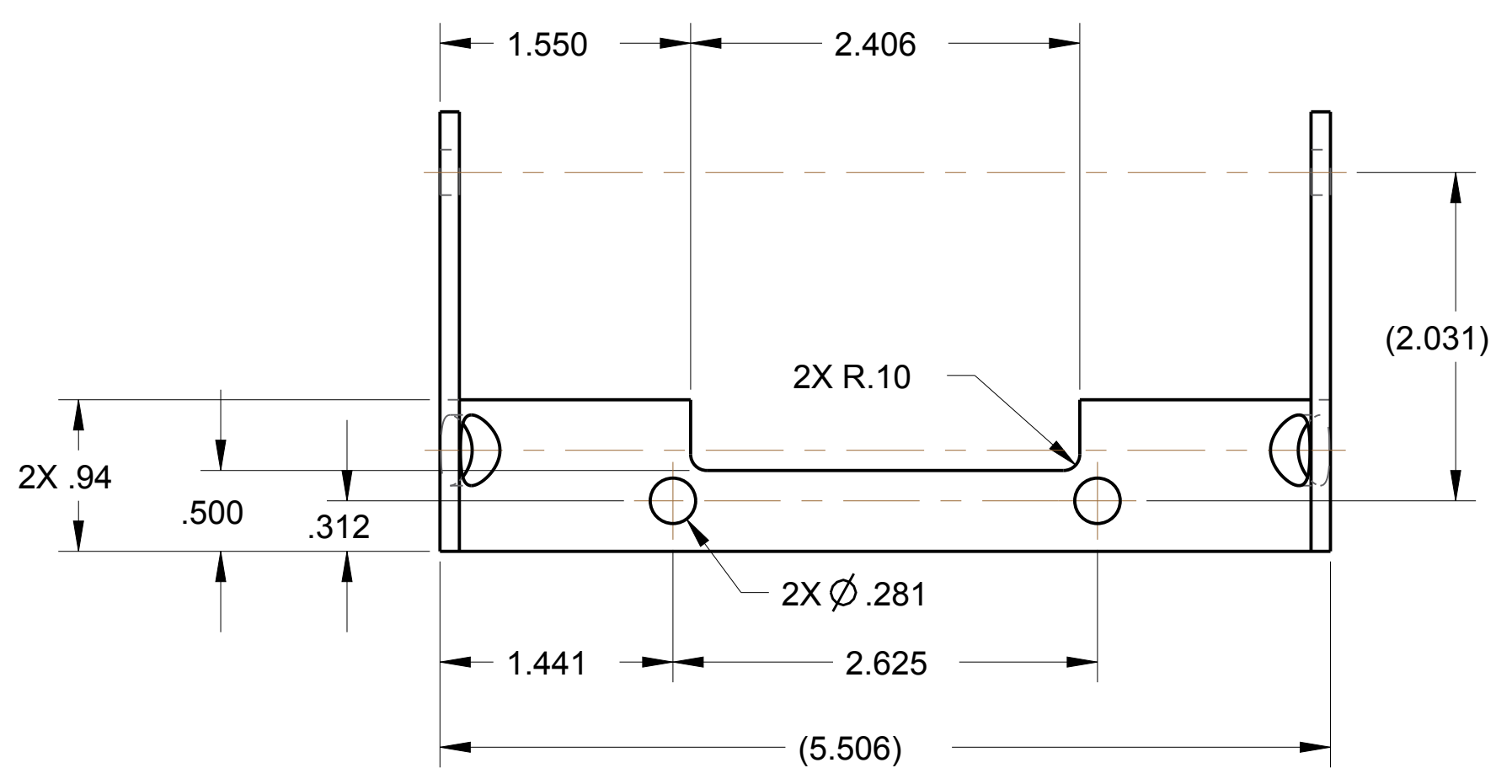
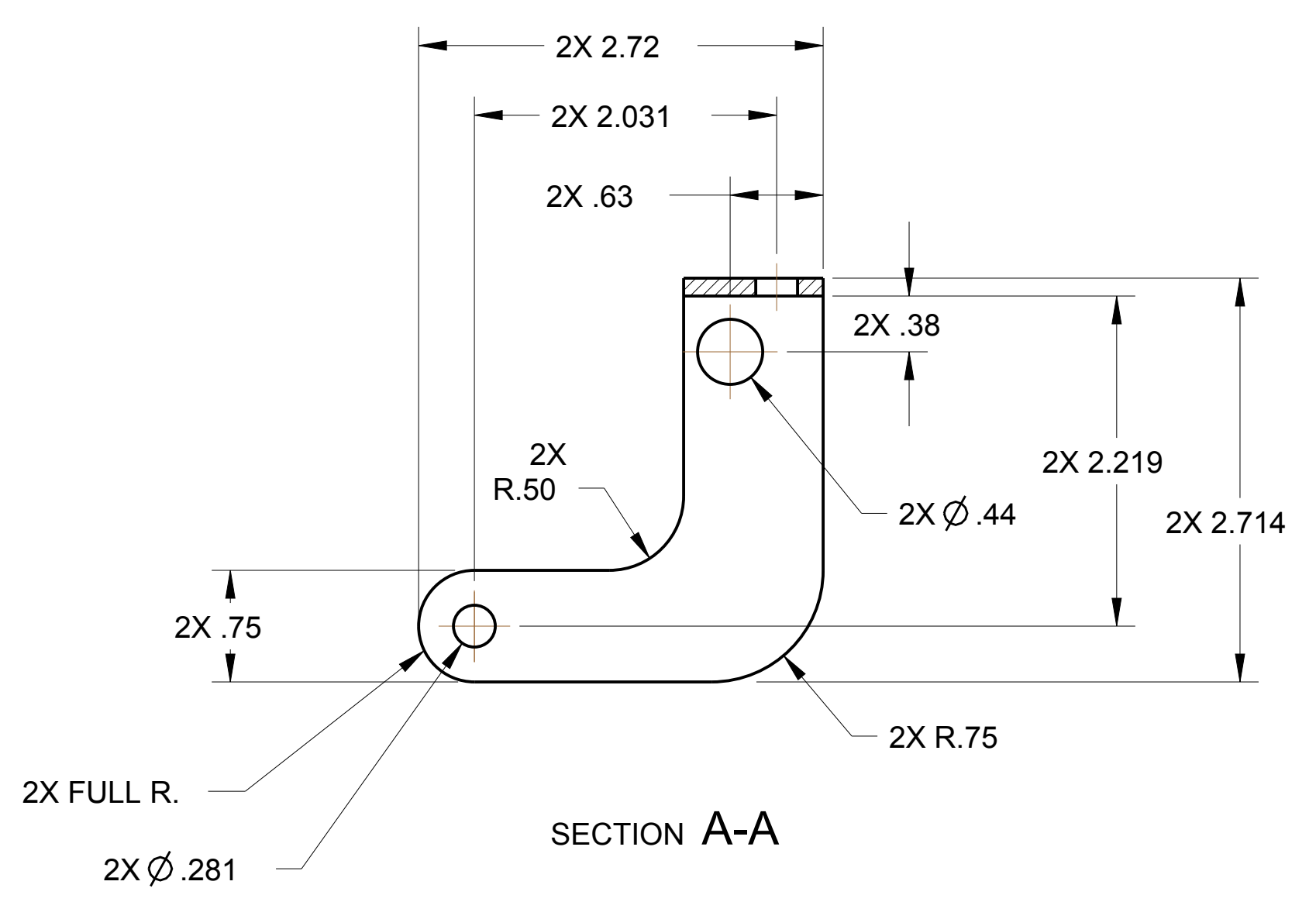
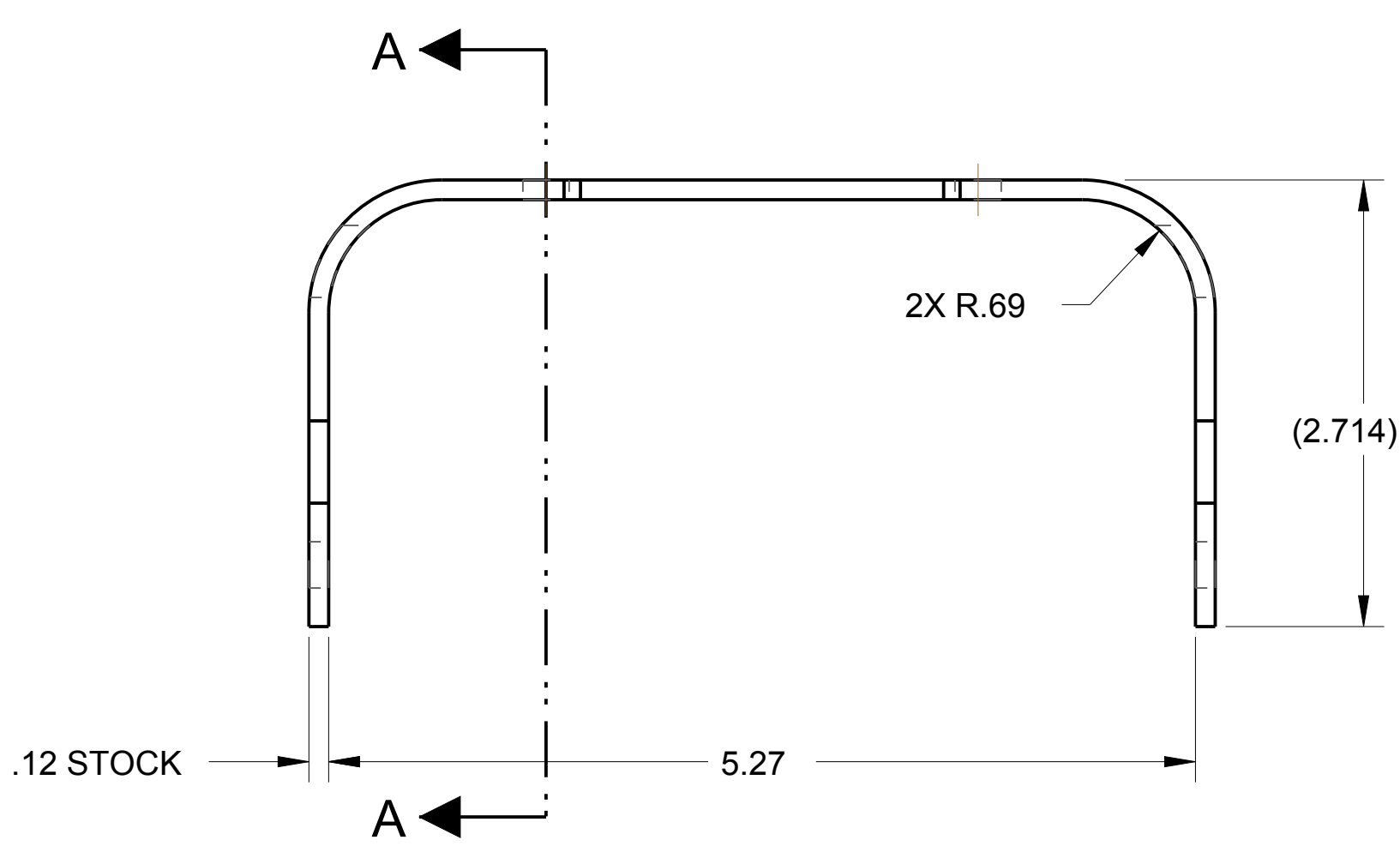
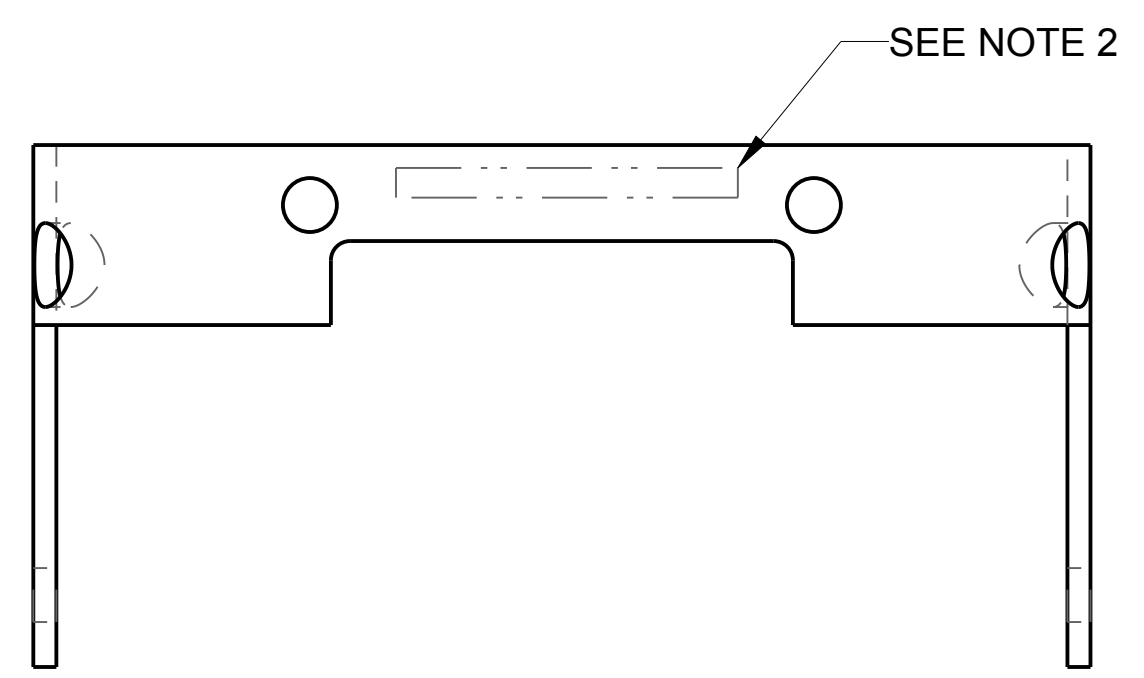

ISOMETRIC VIEW
FOR REFERENCE ONLY

2550M0049		2	125		BREAK SHARP EDGES				COLLIDER-ACCELERATOR DEPARTMENT BROOKHAVEN NATIONAL LABORATORY UPTON, N.Y. 11973			
USED ON DRAWING NO.		QTY. PER ASSY.	FINISH		MAX. .001 IN. 015		DRAWN BY: S. TRABOCCHI 08/24/17 CHECKED BY: S. RESTMEYER 3/19/18 DESIGN APPROVAL: A. ARNO 3/20/18 ENG / FRTY APPROVAL: G. MAHLER 3/20/18 SUPERVISOR APPROVAL: J. TUOZZOLO 3/20/18 CEE / CME DIVISION HEAD QA SAFETY / RSC DEPARTMENT CHAIR		CBETA MAGNET ASSEMBLY BRACKET, MAGNET SUPPORT, TYPE 4			
APPLICATION		Q.A. CATEGORY		SCALE:		WEIGHT:		SHEET OF		REV.		
		A3		1/1		0.3		1 1		A		

8 7 6 5 4 3 2 1 CREO

DWG NO 2550M0076

SHT 1 OF 1

CREO